

Note: wall covering & water resistive barrier as req'd by code.

R-Control Do-All-Ply 1/2" diameter continuous bead.

Field installed bottom plate.

Sill sealer.

Insect clip or flashing.

Sealant.

R-Control Do-All-Ply 1/2" diameter continuous bead.

Protective covering.

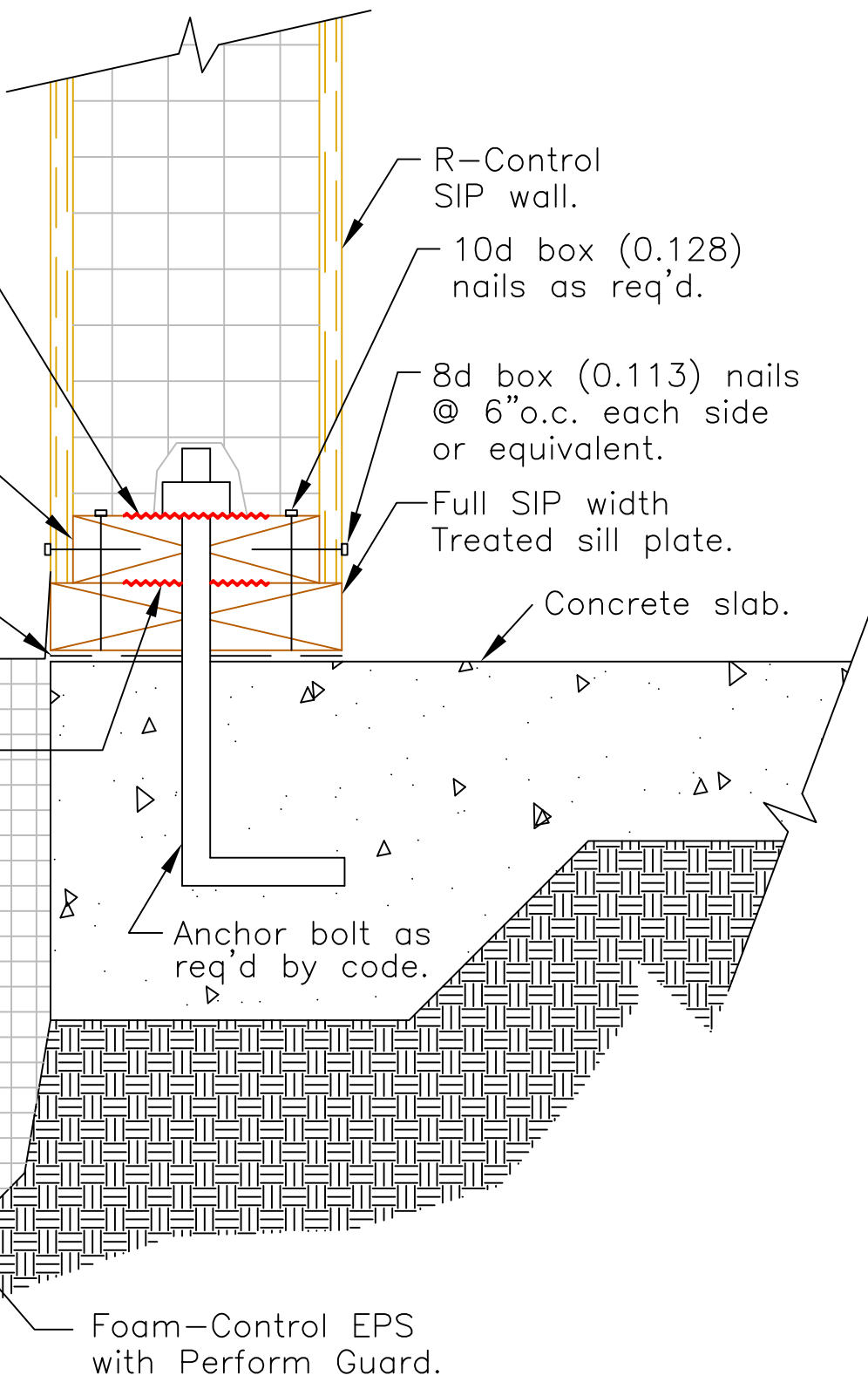

R-Control SIP wall.

10d box (0.128) nails as req'd.

8d box (0.113) nails @ 6"o.c. each side or equivalent.

Full SIP width Treated sill plate.

Concrete slab.

Anchor bolt as req'd by code.

Foam-Control EPS with Perform Guard.

SECTION

Scale: NTS

Updated 1-16-12

R-Control® SIP

TITLE:
Slab Foundation Framing

NO.
SIP-104